



**3 DOUBLE BEDROOMS**

**MODERN FITTED KITCHEN**

**BAY WINDOWS**

**SPACIOUS THROUGH LOUNGE**

**FULLY TILED BATHROOM**

**IMMACULATE CONDITION**



**264 Grove Green Road**  
London, E11 4EN

**Offers in the Region**  
**Of £485,000**

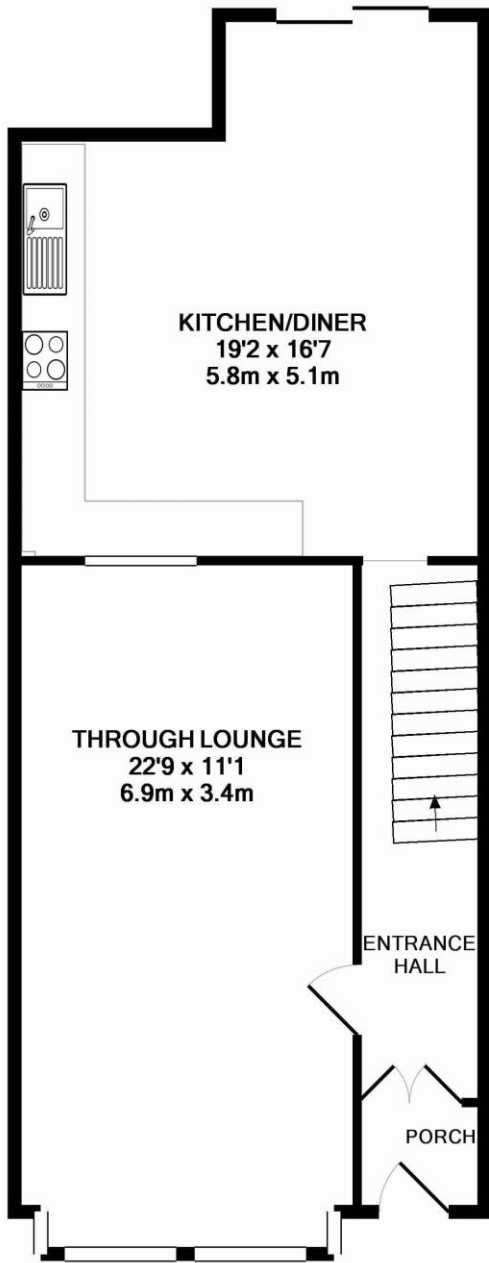

GROUND FLOOR  
APPROX. FLOOR  
AREA 683 SQ.FT.  
(63.4 SQ.M.)

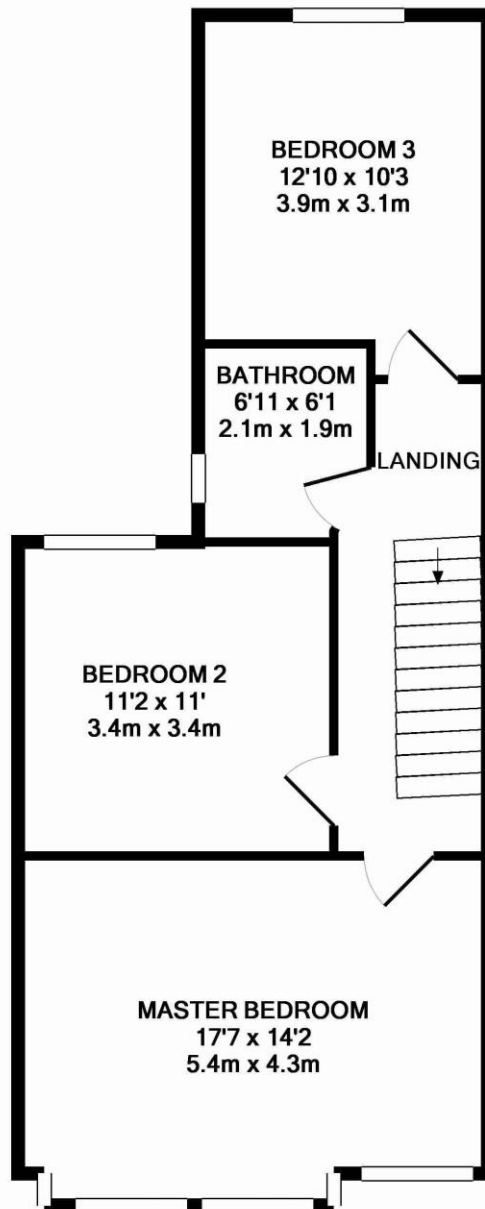

1ST FLOOR  
APPROX. FLOOR  
AREA 569 SQ.FT.  
(52.9 SQ.M.)

TOTAL APPROX. FLOOR AREA 1252 SQ.FT. (116.3 SQ.M.)

Whilst every attempt has been made to ensure the accuracy of the floor plan contained here, measurements of doors, windows, rooms and any other items are approximate and no responsibility is taken for any error, omission, or mis-statement. This plan is for illustrative purposes only and should be used as such by any prospective purchaser. The services, systems and appliances shown have not been tested and no guarantee as to their operability or efficiency can be given  
Made with Metropix ©2015

**MONEY LAUNDERING REGULATIONS 2003**

intending purchasers will be asked to produce identification and proof of financial status when an offer is received. We would ask for your co-operation in order that there will be no delay in agreeing the sale.  
**THE PROPERTY MISDESCRIPTIONS ACT 1991**

The Agent has not tested any apparatus, equipment, fixtures and fittings or services and so cannot verify that they are in working order or fit for the purpose. A Buyer is advised to obtain verification from their Solicitor or Surveyor. References to the Tenure of a Property are based on information supplied by the Seller. The Agent has not had sight of the title documents. A Buyer is advised to obtain verification from their Solicitor. You are advised to check the availability of this property before travelling any distance to view. We have taken every precaution to ensure that these details are accurate and not misleading. If there is any point which is of particular importance to you, please contact us and we will provide any information you require. This is advisable, particularly if you intend to travel some distance to view the property. The mention of any appliances and services within these details does not imply that they are in full and efficient working order. These particulars are in draft form awaiting Vendors confirmation of their accuracy. These details must therefore be taken as a guide only and approved details should be requested from the agents.